

PRISM SPECIFICATION SHEET

TITLE, DATE

ZnSe Prism (Right Angle, Coating) ver.20090410

ORGANIZATION

Astronomical Institute, Tohoku University
980-8578 Aoba, Aramaki, Aoba-ku, Sendai, Miyagi, Japan
phone: +81-22-795-6607
fax: +81-22-795-6513

CONTACT PERSON

Chihiro Tokoku

GENERAL

Intended Use: Astronomical Spectrograph
Wavelength Range: 2.0 - 2.4 μ m
Operating Temperature: ~100 K

PRISM SPECIFICATION

Material: Optically homogeneous ZnSe
Dimension: Please see attached figure
Apex Angle: 18.5 degree \pm 30min
Effective Area: Center of polishing area 64X64mm
Surface Quality: at SIDE-1 Newton Ring \leq 2, astigmatism \leq 1
at SIDE-2 Newton Ring \leq 1, astigmatism \leq 0.5
Surface Accuracy: <1 λ rms
Transmittance: >70% at 2.0-2.4 μ m
Cosmetic Statement: No bubbles and striae
AR Coating: at SIDE-1 Multi-AR against infraction 1.51 (2.0-2.4 μ m)
at SIDE-2 Multi-AR against vacuum air (2.0-2.4 μ m)
Coating Area: Center of polishing area 68X66mm excepting bevel
Surface Finish: Sand-floated #500-1000 unless otherwise stated
Chamfer: C0.1~0.5 unless otherwise stated

OTHERS

Required literature upon delivery: 1, Measured dimensions at 20°C (0.1mm,0.1°accuracy)

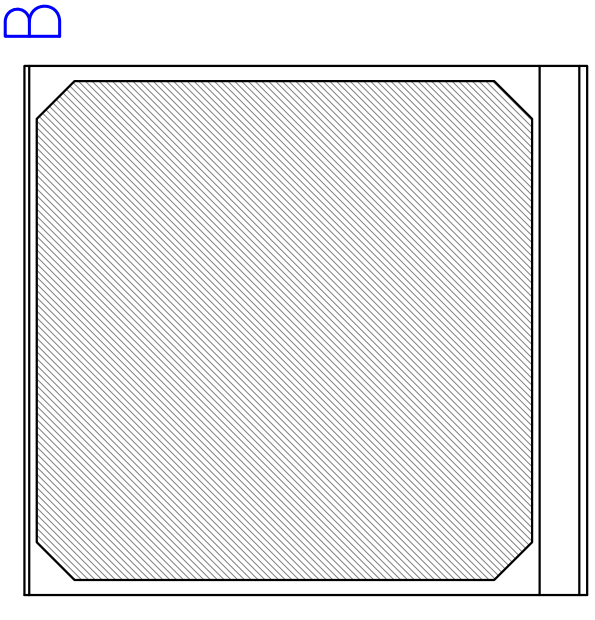
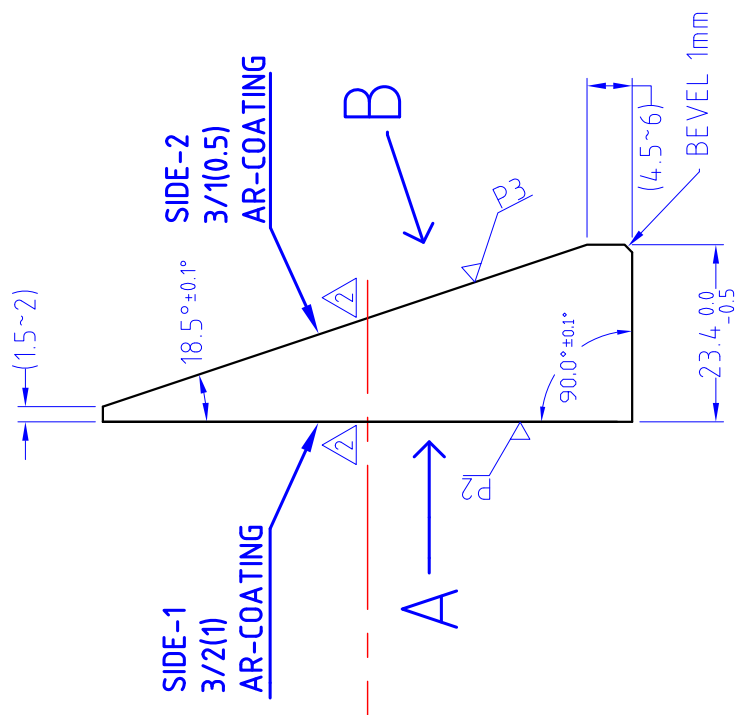
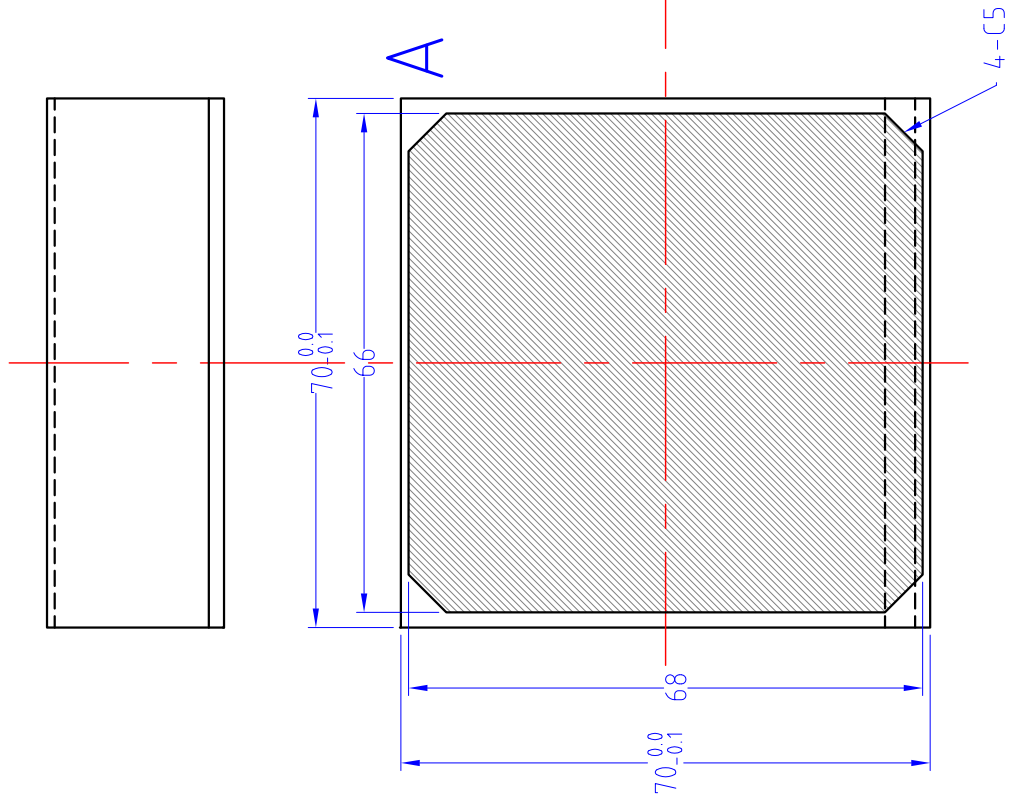
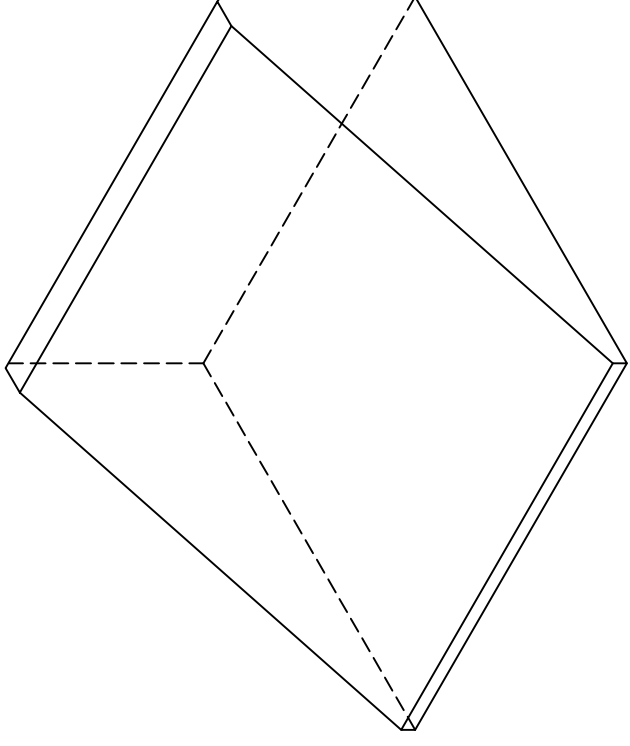

COATING AREA=SHADED AREA

	TITLE	ZnSe PRISM	ORGANIZATION	ASTRONOMICAL INSTITUTE, TOHOKU UNIVERSITY
UNLESS OTHERWISE NOTED	MATERIAL	ZnSe	DESIGN	CHIHIRO TOKOKU
.X +/- .1	DIMENSIONS	mm	REVISED DATE	4/10/2009
.XX +/- .01	QUANTITY	2	DRAWING SIZE	A3
∠ +/- .5	SCALE	1:1		